

⚠ Important Safety Instructions

READ AND SAVE THESE IMPORTANT SAFETY INSTRUCTIONS BEFORE USING THIS APPLIANCE. WHEN USING ELECTRICAL APPLIANCES, BASIC PRECAUTIONS SHOULD ALWAYS BE FOLLOWED TO REDUCE THE RISK OF FIRE, ELECTRICAL SHOCK AND INJURY TO PERSONS, INCLUDING THE FOLLOWING:

1. The appliance should always be placed on a firm, flat, waterproof surface at least four feet away from bedside, six inches from the wall and out of reach of patients, children and pets. Be sure the appliance is in a stable position and the power cord is away from heated surfaces and out of the way to prevent the humidifier from being tipped over.
2. The appliance should not be left unattended in a closed room since air could become saturated and leave condensation on walls and furniture. Leave room door partly open. Do not aim mist output grille directly at children, walls or furniture.
3. Before using the appliance, extend the cord and inspect for any signs of damage. Do not use the unit if the cord has been damaged.
4. The appliance has a polarized plug (one blade is wider than the other) as a safety feature. This plug will fit into a polarized outlet only one way. If the plug does not fit fully into the outlet, reverse the plug. If it still does not fit, contact a qualified electrician. **Do not** attempt to defeat this safety feature.
5. To avoid fire or shock hazard, plug the appliance directly into a 120V AC electrical outlet.
6. The appliance should always be unplugged and emptied when not in operation or while being cleaned. Unplug humidifier before moving. **Do not** move or tilt humidifier while it is in operation. Plug and unplug unit with dry hands. **Never** pull by cord.
7. **Do not** operate the appliance without water. Unplug when tank is empty.
8. **Caution:** To avoid the risk of fire, shock or personal injury, do not use an extension cord.
9. Appliance requires regular cleaning. Refer to, and follow cleaning instructions.
10. **Do not** operate outdoors; this appliance is intended for indoor use.
11. **Do not** cover or insert objects into any openings on the unit.
12. **Do not** attempt to repair or adjust any electrical or mechanical functions on this appliance. Doing so will void your warranty.
13. **Do not** add any medications (e.g., Kaz Inhalant or Vicks VapoSteam®) into Nozzle, Base, Reservoir or Water Tank.
14. For residential use only.
15. **In certain areas, tap water is extremely hard, containing a higher-than-normal concentration of**

various minerals. These minerals can be emitted into the air, possibly causing adverse reactions in people with breathing difficulties. In such cases, use only distilled or demineralized water and clean the humidifier every day. (See **Care and Cleaning** instructions.)

16. **If you have breathing difficulties, consult your physician before using any humidification product.**
17. **In hard-water areas, a white dust may form on furniture as a result of the minerals from the water. This can easily be wiped away with a cloth.** To avoid the white dust, use distilled water.

+ As a condition of sale, the purchaser assumes responsibility for the proper care and use of this appliance in accordance with our printed instructions. The purchaser or user must judge for himself or herself when to use it and how long to use it for.

TROUBLESHOOTING

If the unit does not operate:

- Check that plug is fully inserted into wall outlet.
- Check airflow. Are there any obstructions preventing airflow?
- The motor contains a temperature-limiting fuse. If the motor overheats, the fuse will trip and shut off the motor. Unplug the unit and contact our Customer Service Department. Do not attempt to repair the motor yourself.

If you do not obtain enough humidity:

- BECAUSE OF BREAK-IN CHARACTERISTICS, MAXIMUM OUTPUT WILL NOT BE REACHED UNTIL THE UNIT HAS BEEN USED SEVERAL TIMES.
- If the air in the room is extremely dry, there will be greater absorption of the vapor and faster depletion of the water reservoir. As the humidity increases, output will decrease and adding of water will be required less frequently. This variation is normal.
- Under certain conditions the moisture output may not be visible. The humidifier is operating properly if the water level continues to go down during usage, even when you cannot see the vapor.

If you are obtaining too much humidity and water falls out around the unit:

- Room air may be excessively humid (greater than 60% relative humidity); do not use humidifier. Oversaturated air can cause **condensation in front of the unit, on wall or furniture.** For proper humidity readings, use a humidity monitor available at most hardware and department stores.
- The humidifier needs cleaning. Follow **Care and Cleaning** instructions.

• Medication or other additives may have been added to the water. Follow **Care and Cleaning** instructions.

If the unit is making a rattling noise:

- Check to make sure pickup tube is on tightly and the head is on correctly.
- Reposition the unit and make sure it is on a level surface.

Limited Warranty

You should first read all instructions before attempting to use this product.

- A.** This 3 year limited warranty applies to repair or replacement of product found to be defective in material or workmanship. This warranty does not apply to damage resulting from commercial, abusive, unreasonable use or supplemental damage. It also does not apply to the DynaFilter cartridge. Defects that are the result of normal wear and tear will not be considered manufacturing defects under this warranty.

KAZ IS NOT LIABLE FOR INCIDENTAL OR CONSEQUENTIAL DAMAGES OF ANY NATURE. ANY IMPLIED WARRANTY OF MERCHANTABILITY OR FITNESS FOR A PARTICULAR PURPOSE ON THIS PRODUCT IS LIMITED IN DURATION TO THE DURATION OF THIS WARRANTY.

Some jurisdictions do not allow the exclusion or limitation of incidental or consequential damages or limitations on how long an implied warranty lasts, so the above limitations or exclusions may not apply to you. This warranty gives you specific legal rights, and you also may have other rights which vary from jurisdiction to jurisdiction. This warranty applies only to the original purchaser of this product from the original date of purchase.

- B.** At its option, Kaz will repair or replace this product if it is found to be defective in material or workmanship. Defective product should be returned to the place of purchase in accordance with store policy. Thereafter, while within the warranty period defective product may be returned to Kaz.
- C.** This warranty does not cover damage resulting from any unauthorized attempts to repair or from any use not in accordance with the instruction manual.
- D.** Return defective product to Kaz USA, Inc. with a brief description of the problem. Include proof of purchase and a \$10.00 check or money order for handling, return packing and shipping charges. Please include your name, address and a daytime phone number. **You must prepay shipping charges.**

Send to: Kaz USA, Inc.
Attn: Returns Department
4755 Southpoint Drive
Memphis, TN 38118 USA

Order Information

To order replacement parts or DynaFilter PK14-3W cartridge, follow these simple instructions:

Via The Internet: Visit the Kaz Store at www.kazstore.com for a complete selection of filters and cleaning treatments. Bulk sales are also available as a money-saving option.

By Phone: Call toll-free by dialing 1-800-VAPOR-1-2 (1-800-827-6712). Please have your credit card handy for payment. We accept Visa and Master Card. Minimum credit card order is \$10.00.

By Fax: Fax your order to Kaz Consumer Relations Orders at 1-508-481-0509. Please clearly print your name, mailing address and products ordered. Be sure to specify Visa or Master Card, card number and expiration date, and sign your order. Minimum credit card order is \$10.00.

By Mail: Mail your order to Kaz Consumer Relations Orders, 250 Turnpike Road, Southborough, MA 01772. Please clearly print your name, mailing address, and products ordered. Enclose check or money order (no cash, please).

kaz Manufacturing Quality Healthcare Products for Over 75 Years

Kaz USA, Inc.
250 Turnpike Rd.
Southborough, MA. 01772 USA
www.kaz.com/vicks

© 2013 Kaz USA, Inc.
All rights reserved.
31M420V190



CoolMist Humidifier

USE AND CARE MANUAL



Model
V425

IMPORTANT!

READ AND SAVE THESE INSTRUCTIONS

For owner's manuals in other languages, visit <http://www.mvh.kaz.com/oms>
Para Manuales de Usuario en otros idiomas, visite <http://www.mvh.kaz.com/oms>

How Your Humidifier Works

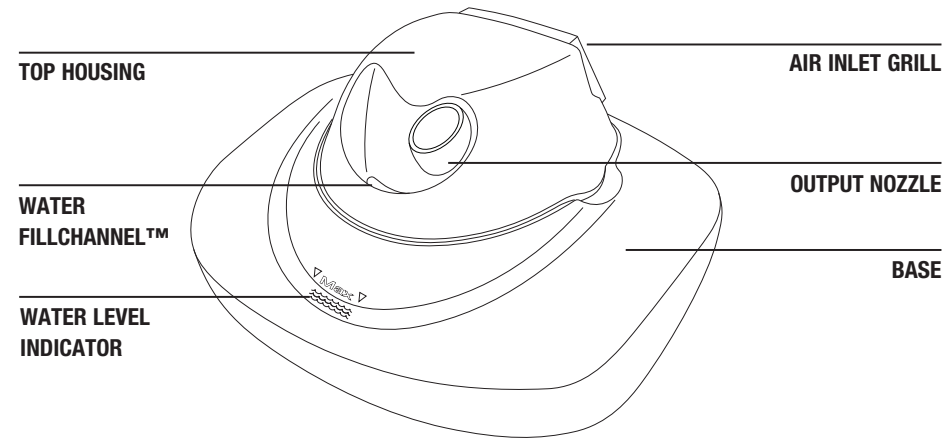

The Vicks® Cool Mist Humidifier produces a cool mist through cyclone technology. The motor-driven impeller draws up water through a pickup tube. Centrifugal force throws the water through a screen into the vortex chamber, breaking up the water into a superfine, cool mist. This humidifier adds water vapor to the surrounding air, enabling the user to breathe better and sleep more comfortably.

This humidifier should not be left unattended in a closed room since air could become over-saturated and leave condensation in front of the unit, on walls and furniture. It is recommended to leave room door partially open.

The Air Cleaning DynaFilter®

The Vicks Cool Mist Humidifier includes the exclusive Protec Air Cleaning DynaFilter PK14-3W.



Under normal environmental conditions, the filter cartridge should be replaced every two months. Replacement time will vary depending upon the concentration of pollutants in the air. If you notice heavy dirt accumulation on the filter or if the humidifier output is significantly reduced, **it's time to change to a new DynaFilter!** Protec DynaFilter PK14-3W cartridges are available at leading pharmacies and drug departments. You may also order directly from Kaz (see Order Information in this manual).

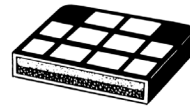

Read and Save These Instructions

1. **CAUTION: UNRAVEL CORD BEFORE USE.** Failure to do so could cause overheating and possible fire hazard. Always disconnect cord at wall plug before removing the Top Housing or when humidifier is not in use.
2. **PLACE HUMIDIFIER IN A SAFE POSITION** on floor, table or other FIRM, FLAT and LEVEL surface. Protect rug, floor or furniture by placing unit on a waterproof non-conducting pad or mat for protection against inadvertent spillage. **Do not** place any object over the humidifier; it could block air openings.

Cord should be out of the way, where it cannot be pulled or stepped on.

When used therapeutically, the humidifier should be placed at least 4 feet from bedside and out of the reach of children.

3. **FILL CAREFULLY.** The exclusive FillChannel™ permits convenient filling without removing the Top Housing. Pour cool tap water into FillChannel™. Fill until water level reaches Water Level Indicator on the front of bowl. **IMPORTANT: DO NOT OVERFILL,** as this will cause water spillage and possible damage to floors or furniture.
4. **PLUG IN HUMIDIFIER.** Plug power cord into wall.

CAUTION: DO NOT PLUG IN THE CORD WITH WET HANDS; ELECTRIC SHOCK COULD RESULT.

This product has a polarized plug (one blade is wider than the other) as a safety feature. The plug will fit into a polarized outlet only one way. If the plug does not fit properly into the outlet, reverse the plug. If it still does not fit, contact a qualified electrician. **Do not attempt to defeat this safety feature.**

CAUTION: Turn off the humidifier if moisture condenses on surfaces or walls. Room air may be excessively humid.

IMPORTANT: To maintain proper operation of your humidifier, be sure to follow **Care and Cleaning** instructions.

Care and cleaning

Tap water may contain pollutants and minerals (scale) that can deposit on the inner surfaces of the humidifier. Such scale can accelerate the growth of microorganisms and it is important that periodic cleaning is performed as outlined below. More frequent cleaning may be necessary if you notice a heavy buildup of scale.

Daily Maintenance

1. Unplug cord from electrical outlet.
2. Remove Top Housing and place upside down on a flat surface. Do not set down on the Pickup Tube. Rinse Base, wipe clean, and dry with a clean cloth or paper towel.
3. Wipe exterior surfaces of the Top Housing with a soft, dry cloth. **CAUTION: DO NOT USE WATER TO CLEAN THE TOP HOUSING. ELECTRIC SHOCK MAY RESULT OR HUMIDIFIER MAY BE DAMAGED. DO NOT IMMERS**E TOP HOUSING IN WATER.
4. Replace Top Housing. Humidifier is now ready for use.

Weekly Maintenance

Removing Scale

1. Unplug cord from electrical outlet.
2. Remove Top Housing and place **upside down** on a flat surface. **Do not set down on the Pickup Tube.**
3. Empty any remaining water from Base.

Care and Cleaning (continued)

4. Carefully loosen the Pickup Tube from the housing by holding the Disk and rotating the Pickup Tube counterclockwise in the direction of the "OFF" arrow located at the base of the Pickup Tube. **(Figure A)**
5. Soak Pickup Tube in undiluted white vinegar. Let stand for 20 minutes.
6. Dampen a soft, clean cloth or sponge with undiluted white vinegar and wipe out Base, Pickup Tube and walls around the Pickup Tube. **CAUTION: DO NOT** use soap, detergents or abrasive cleaners.
7. Rinse Pickup Tube and Base thoroughly in clean, warm water until scale particles are removed.
8. Wipe exterior surfaces of the Top Housing with a soft, dry cloth. **DO NOT IMMERS**E OR **SPRAY WATER ON THE TOP HOUSING.** You are now ready to disinfect the base.

Disinfecting the Base

1. Fill Base with 1 teaspoon of household bleach in 1 gallon of water. Place the Pickup Tube in the Base and let remain for 20 minutes. Stir every few minutes to ensure that all surfaces are coated.
2. Empty Base after 20 minutes. Thoroughly rinse the Base and Pickup Tube with water until bleach smell is gone. Dry with clean cloth or paper towel.
3. Wipe all exterior surfaces of the Top Housing with a soft, dry cloth. **BE CAREFUL NOT TO IMMERS**E OR **SPRAY WATER ON THE TOP HOUSING. ELECTRIC SHOCK MAY RESULT OR HUMIDIFIER MAY BE DAMAGED.**
4. Carefully re-attach Pickup Tube by inserting the prongs into the slots in the Disk. While holding the Disk steady, rotate the Pickup Tube clockwise in the direction of the "ON" arrow located at the base of the Pickup Tube. **(Figure B)**
5. Replace Top Housing on Base. Humidifier is now ready for use.

End Of Season Maintenance

OR WHEN HUMIDIFIER WILL NOT BE IN USE FOR AT LEAST ONE WEEK

1. Clean and dry the humidifier thoroughly as per the **Weekly Maintenance** instructions above.
2. Store in a cool, dry location. **DO NOT STORE WITH WATER INSIDE THE BASE.**

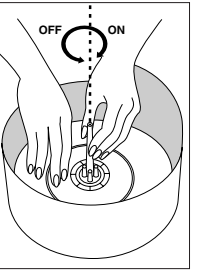

Figure A

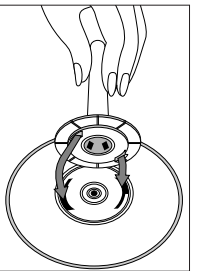

Figure B